

DTE Energy[®]



**MichCon Broadway Facility
2012 Remediation Plan**

**Shayne Wieseemann
Abed Houssari**

Presentation for Ann Arbor City Council - March 12, 2012

Ann Arbor Manufactured Gas Plant History

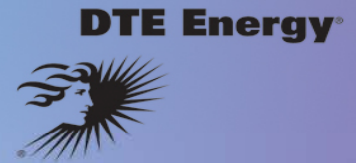

12-acre M1-zoned property located along the Huron River in Lower Town



- 1900 – Manufactured Gas Plant (MGP) constructed on eastern portion of property by the Ann Arbor Gas Company.
- 1914 – Ann Arbor Gas Co. reincorporated as Washtenaw Gas Co.
- 1938 – MichCon acquires gas plant during consolidation.
- 1939 – Natural gas supplied to City of Ann Arbor.
- Late-1950s – MGP decommissioned.
- Early-1960s – MichCon Broadway Service Center constructed.
- 2009 – Service center deconstructed.



Site Environmental Progress



- Site investigation complete.
- Excavation of 1,680 cubic yards of impacted soil from the western parcel.
- Installation and operation of the groundwater treatment system.
- Routine groundwater monitoring and reporting.
- Excavation of 4,340 cubic yards of impacted soil from the eastern parcel.
- MichCon has spent \$2.6MM performing site investigation and cleanup of 7,500 tons of soil and 1.3 million gallons of groundwater.

Investigation Results and 2012 Remediation Plan

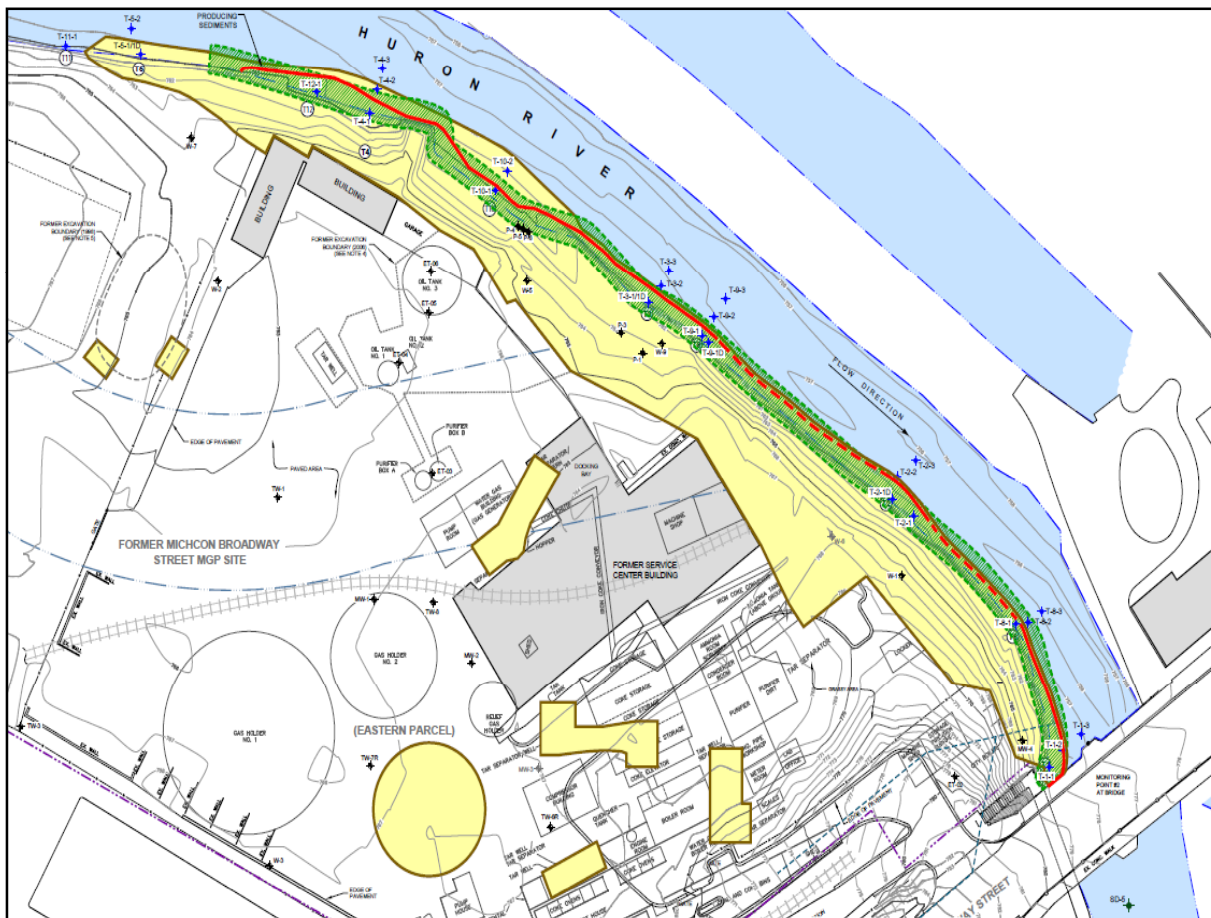

- 287 soil boring and soil testing locations, 34 wells, and 125 sediment testing locations resulting in thousands of test results.
- Some MGP structures and shallow soil/sediment impacts remain.
- Remaining impacts are well defined and do not pose an immediate risk to human health or the environment.
- Our remediation plan is being approved by MDEQ and will be fully protective of human health and the environment.



Remediation Plan Implementation

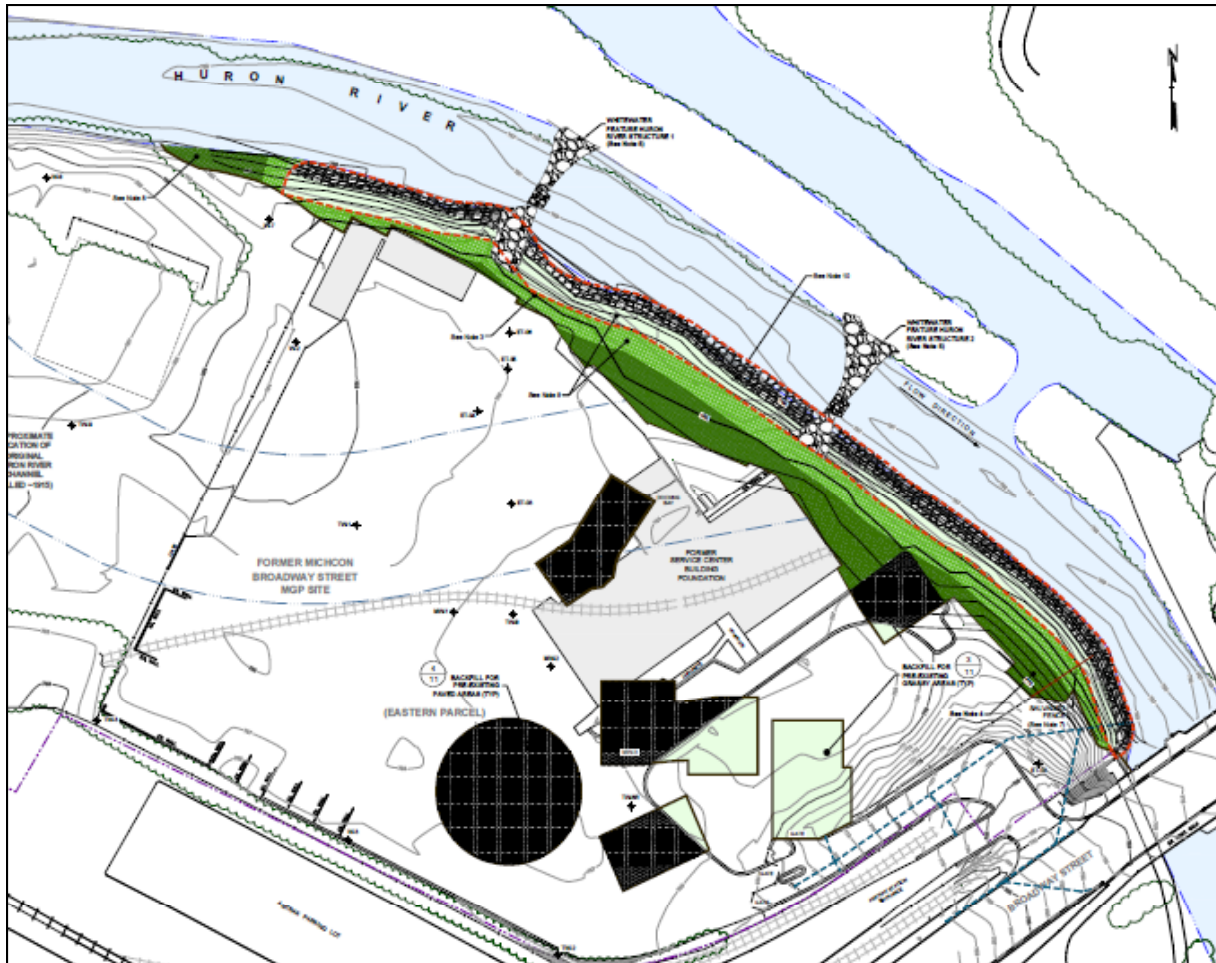

Site Controls

- Site security
- Surface water protection
- Air monitoring
- Odor control
- Wheel washing
- Traffic control

Restoration

- Whitewater feature installation
- Habitat improvement and bank stabilization
- Debris removal
- Native plantings



Schedule

Schedule

- Predesign Studies Report – Submitted to MDEQ (November 2011)
- Response Activities Plan – Submitted to MDEQ (February 2012)
- Construction Permit Application – Submitted to MDEQ (February 2012)
- City Council Work Session Presentation – March 12, 2012
- Parks Advisory Commission Presentation – March 20, 2012
- Preconstruction Activities and Engineering – March 2012 – July 2012
- MDEQ Public Meeting/Public Hearing – April 11, 2012
- Receive MDEQ Plan Approval and Permit – June 2012
- Contractor Bid and Selection – July 2012
- Construction – August – October 2012 (2.5 months)