



TO: Ann Arbor Public Art Commission

FROM: Aaron Seagraves, Public Art Administrator

DATE: August 20, 2013

SUBJECT: EXECUTIVE REPORT ON JOSHUA WIENER'S DESIGN FOR PUBLIC ART AT THE KINGSLEY AND FIRST RAIN GARDEN

OVERVIEW OF PUBLIC ART PROJECT:

The City of Ann Arbor entered into a contract with artist Joshua Wiener, of Boulder, Colorado, to design fabricate and install a public artwork at the location of an upcoming rain garden on Kingsley and First Street in May, 2013.

Joshua Wiener was selected based on his submission to the City issued Request for Proposal #841, which had a January, 10th deadline.

The artwork and the rain garden have been designed in a collaborative process between the rain garden's landscape architect and the artist. This design process enabled a fully integrated design for both the art element and the rain garden. The completion of a conceptual design for the artwork was not a part of the artist selection process. The landscape architect is Conservation Design Forum.

The artist's budget for the project is \$23,380. The funding for the art project comes from the pooled public art funds established by the Public Art Ordinance sourced from storm water capital improvement projects. Public art funds are not being used for the installation of the rain garden; however public art funds used in an amended contract with the landscape architect for up to 9 hours of design work with the artist.

ARTIST'S PROJECT DESCRIPTION AND STATEMENT:

This sculpture was created from a robust exploration of the Kingsley and First Street Rain Garden. This entire space is the result of collaboration between the general public, art council, landscape architect and me, the artist. Through this process, water became the key element that informed this artwork.

Water has emerged in a number of ways through this design to connect the artwork to how the land functions and what the rain garden will do for the quality of life in this area.

The significance of water on this site is represented by having fish on the land. They are emerging to articulate how this rain garden is an extension of the river. The fish evoke water and the shape of their bodies creates waves that give an additional suggestion of water on the land. As the audience passes the piece, the fish will change positions in relation to one another. The sculpture will have a kinetic feel without any moving parts. The fish will appear to be swimming and the outline of their fins will create overlapping waves, adding to the feeling that water is moving on this site. The landscape and the art have been woven together. The plants will be placed in a way that conveys the surface of water with long flowing lines along the same orientation as the fish. There are also shapes in the landscape that suggest shadows of the fish.

This sculpture is composed of 5 outlines of small mouth bass. The largest will be just under 8' tall and 20' wide and ~5" deep. The thickness will be determined with a structural engineer. The fish will be epoxy painted for ease of maintenance. This surface is easy to restore from graffiti and can be reapplied in the field. It will be attached to a robust foundation with stainless steel hardware. Two of the fish will have enlarged surfaces where they can be used as a bench.

This artwork will poetically tell the story of the rain garden. I am excited about this design because the artwork has layers of meaning and experience. The audience becomes an active part in the artwork and hopefully is drawn into a state of curiosity about our environment.

-Joshua Wiener, August, 19, 2013

OTHER ART PROJECT DETAILS:

Timeline

August - final acceptance of design

September - Engineering

October - Begin fabrication

March - Installation of foundation and sculpture when ground is thawed

Sculptures will also be installed before the spring planting.

Sizes of fish, thickness will be determined with a structural engineer

- 8' x 20'

- 7' 2" x 19' 2"

- 6' 8" x 18' 8"

- 5' 10" x 17' 10"

- 3' 4" x 17'

Wiener presented the design to the public on July 12th. There were approximately 12 members of the public in attendance and feedback was collected.

See ATTACHMENT A for written feedback collected at the presentation.

Project budget is ATTACHMENT B.

Overhead view of design within the rain garden layout.



Street view of the design.



Landscape design by Conservation Design Forum.

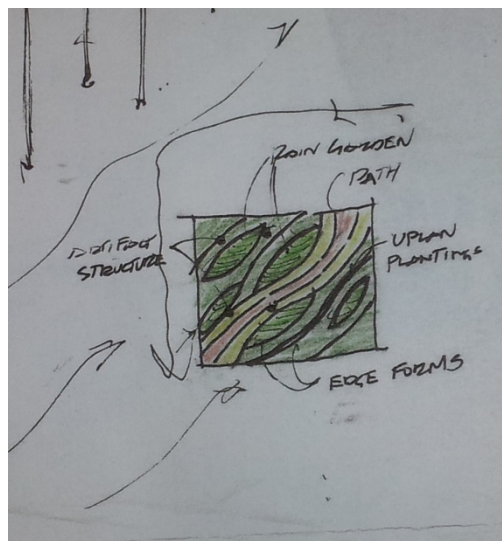

SELECTION PANEL'S RECOMMENDATION AND REVIEW OF DESIGN:

The Selection Panel for the project met on the 2nd and they approved the concept design as presented. The Selection Panel did have feedback, questions and suggestions, for the artist:

Orientation of the Fish

The fish are pointed toward the river. This was viewed as a matter of intent for the artist to decide, however they were thought to be pointed in an unnatural direction. It was thought fish would typically swim the opposite direction. Panel did agree that pointing the fish to the river could be a philosophical statement regarding the environmental connection to the river.

White or Brown Color

Panel agreed on the white color application. Although, it was dependent upon how it would affect the budget and if it would mean scaling back the number of sculptures. Panel did not favor a brown color.

If seating is intended upon the sculpture, there was agreement that the sculpture should not be unpainted.

Other Feedback

Suggestion was made to have an odd number of sculptures.

Small signage could be created and installed near the seating area, or etching could be applied to the fish to create sign/messaging.

Unanswered Question

Will the low lying sculptures be covered by vegetation?

Details Needed

The Panel discussed the maintenance. The City requires a maintenance plan and cost estimate of future maintenance. Some questions were discussed regarding maintenance, they asked that the artist.

- Plan for removing graffiti
- Proof that the sculpture will remain secure and be permanent
- Is the sculpture resistant to rust and how does the paint/coating affect rust?

Panel asked for a written description of the artwork.

OTHER PROJECT AND PROCESS INFORMATION:

This location and rain garden was approved by the Public Art Commission as a location for artwork. The City of Ann Arbor began plans to use the location as a rain garden after it was awarded a Federal

Emergency Management Agency (FEMA) grant to purchase properties at 215 & 219 W. Kingsley St., Ann Arbor (one vacant and the other with a structure), demolish the structure, and stabilize the site. Separate from the FEMA Grant, the rain garden installation at the site was determined to be necessary to prevent/minimize flooding in the area by increasing the potential for stormwater infiltration. The site is located within a floodplain. This location will be maintained as open space in perpetuity.

The initial design process has included public engagement. The artist has participated in three meetings with the public since entering into a contract with the city. In addition, survey was conducted prior to the start of the design's creation to gather public input about the location and the desired art work.

The artist attended public engagement meetings the week following the design presentation. He attended the Ann Arbor Public Art Commission's information table at the July 15th Townie Street Party. A meeting at the project site the following day, Tuesday, July 16th was also scheduled, however, it was not well attended, but CTN did conduct an interview with the artist at that time.

ATTACHMENT A

SURVEY FEEDBACK

from the Selection Panel and the public attending the July 12th presentation of the art design

Question One:

What do you think is the most important factor presented in this design?

- Cost effectiveness and use of material with goal of rain garden
- It is responsive to the site and the ecology of Ann Arbor. Sense of movement-fish rising and lowering-jumping, creates a fun experience. It is clever to create movement with a static piece
- Visually in motion
- Effectiveness of rain garden to address over-loading of sewer system.
- Design is excellent; playful yet sophisticated; very pleasant approach to solving a problem

Question Two:

How would you feel about this artwork at the rain garden location?

- I think it is a cost effect and appropriate solution to this problem and budget
- Nicely done
- Excellent
- Definitely would not want the fish to be white—I think it looks cartoonish. As it happens, it would be less expensive not to have white coating, and the look of oxidized steel is more natural and appealing. I did not see white in the artist's other wonderful designs.
- Love it! In white
- Don't really care for it there haven't been fish there in 10,000 years

Question Three:

Comment on how the artwork is integrated with the rain garden? What do you like and dislike about the design?

- Nicely integrated. More development regarding the final proposal but a lovely start.
- Well integrated with rain garden
- I like everything, particularly the white color
- Like the idea of bringing the imagery of the river into the neighborhood. And having a couple of benches that would be comfortable as seating but not for sleeping. Also like that figures will be more or less visible at different seasons.

- I like all the considerations—benches, paths and vegetation.
- Worried about the installation holding up and also interfering with the garden function.

ATTACHMENT B

Joshua Wiener



♦2695 Dartmouth Ave. ♦ Boulder, CO 80305 ♦ 303-447-2396 ph ♦ 303-908-2396 mobile ♦ flowcus@gmail.com ♦ www.joshuaw Wiener.com ♦

EXHIBIT A **FEE PROPOSAL**

(THIS IS AN ESTIMATED BUDGET BASED ON PROFESSIONAL EXPERIENCE AND IDEAS FOR PROJECT)

ARTIST FEE		
Includes time for meetings, presentations, communications, etc.		\$ 2,500
DESIGN DEVELOPMENT		
Preliminary Design Development/Consultations w Architects, Engineers, etc.		\$ 350
Artist Design Fee		<u>\$ 800</u>
	Sub-total	\$ 1,150
PROFESSIONAL SERVICES		
Water-jet cutting		\$ 2,000
Engineer		<u>\$ 750</u>
	Sub-total	\$ 2,750
MATERIALS		
Stone and Steel		\$ 3,500
SHIPPING		
Delivery of materials to studio		\$ 1,000
Delivery of sculpture to site		<u>\$ 1,500</u>
	Sub-total	\$ 2,500
FABRICATION		
Stone & Steel		\$ 3,000
INSTALLATION		
Foundation		\$ 1,000
Fork-lift at installation site		\$ 500
Travel (Airfare/Car Rental/Lodging/Food)		<u>\$ 2,900</u>
	Sub-total	\$ 4,400
GENERAL OPERATING		
Insurance		\$ 250
Studio		<u>\$ 1,000</u>
	Sub-total	\$ 1,250
CONTINGENCY		\$ 2,330
TOTAL		<u><u>\$23,380</u></u>